

Wrist Brace

Fitting / Care Instructions

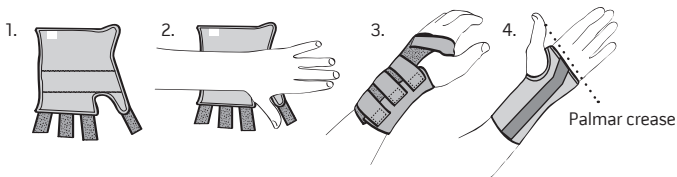

1. Open hook / loop fastening and open brace out flat.
2. Position hand in brace as shown
3. Close hook / loop fastening and re-adjust for comfort as required.
4. Ensure end of brace is not above palmar crease.

Care Instructions

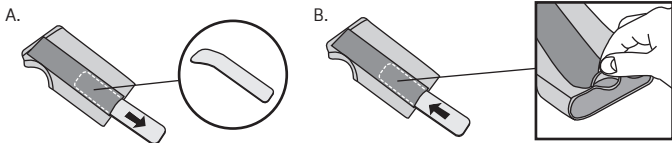

1. Remove metal splint (See diagram A)
2. Close over all hook/loop straps.
3. Hand wash brace in cool water.
4. Rinse.
5. Dry flat.
6. Do not spin or tumble dry.

Important:

Before using brace again, replace metal splint ensuring splint is correct way round and splint is tucked under edge / 'lip' of pocket. (See diagram B)